

# InstaLay 30

## ACOUSTIC UNDERLAYMENT

InstaLay 30 is a high performance acoustic underlay made from recycled rubber crumb that significantly reduces impact sound at source

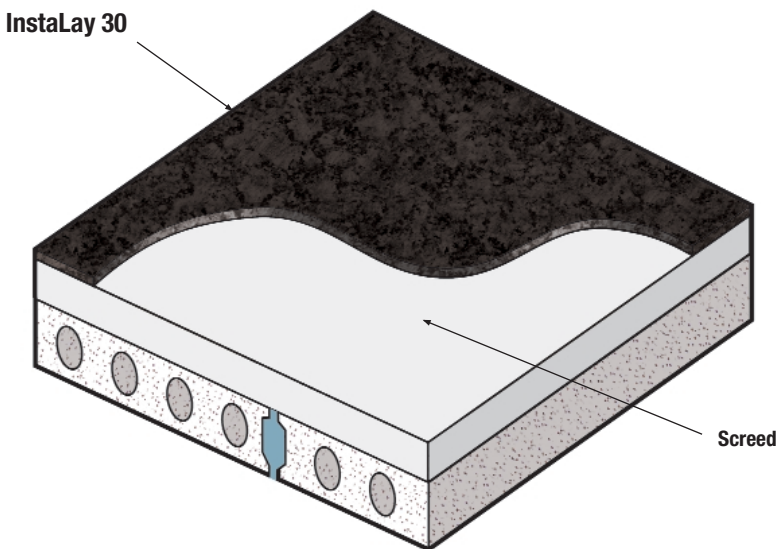

The InstaLay system has the benefit of being supported internally by recycled vulcanized rubber crumb granules, unlike traditional foam and textile underlays. The advantages are that when InstaLay is compressed the rubber granules provide outstanding cushioning performance but, when the pressure is released, these granules immediately return to their original shape. In addition to being non-collapsing, they will not degrade over time and have excellent acoustic and thermal properties.

InstaLay is also available with an innovative Peel & Stick self-adhesive membrane. By significantly reducing the need for adhesive, this InstaLay system revolutionises the way in which carpets, sheet flooring and wood floors are fitted by reducing labour times by over 50% to enable rapid, high quality, single and double-stick installations without mess and delays.

## BENEFITS

- Excellent acoustic and thermal insulation
- Suitable for bonding to all types of structural floor
- Suitable for single and double-stick applications
- Significantly reduces impact sound at source
- High quality and durable – will not deteriorate or collapse
- Gives exceptional comfort, stability and performance
- Can be used with under-floor heating systems
- Guaranteed for 10 years

## APPLICATIONS

- Suitable for sheet vinyls, all types of carpet, carpet tiles, laminates and wood floors
- NBS Clauses available for K21 & M50

## PRODUCT SPECIFICATION

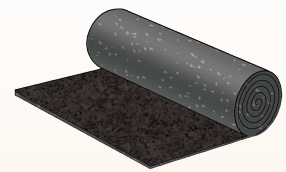

### InstaLay 30

Acoustic underlay manufactured from recycled rubber.

**Roll width:** 1000mm

**Roll length:** 15m

**Roll thickness:** 3mm

**(Also available in a Peel & Stick option)**

### Acoustic Performance

**Weighted reduction in impact sound:** 21dB



**InstaFloor**  
SUPPORTING YOUR WORLD

Insta House, Ivanhoe Road,  
Hogwood Business Park,  
Finchampstead, Wokingham,  
Berkshire. RG40 4PZ. UK

Tel: +44 (0)118 973 9560

Fax: +44 (0)118 973 9547

Email: [sales@instafloor.co.uk](mailto:sales@instafloor.co.uk)

[www.instafloor.co.uk](http://www.instafloor.co.uk)

# InstaLay 30

## ACOUSTIC UNDERLAYMENT

### PERIMETER DETAIL SECTIONS

- Wood floor installations – Install InstaLay 30 to the perimeter of the room and isolate the skirting from the wood floor to avoid flanking sound transmission.

### ACOUSTIC PERFORMANCE

- Weighted reduction of impact sound pressure level ( $\Delta L_w$ ) 21dB. Measured in accordance with BS EN ISO 140-8:1998 and calculated in accordance with BS EN ISO 717-2:1997

### NBS CLAUSES

- **K21 Wood strip / board fine flooring / linings**
  - 111 WOOD FLOATING FLOOR • 115 WOOD LAMINATE FLOORING
  - 145 COMPOSITE LAMINATE FLOORING • 146 LAMINATE FLOORING
- **M50 Rubber / plastic / cork / lino / carpet tiling / sheeting**
  - 110 TILING • 130 CARPET TILING • 138 NEEDED CARPET TILING
  - 146 NEEDED PILE CARPET TILING • 150 SHEETING
  - 155 PVC SHEET FLOORING IN SPECIAL WET AREAS • 170 CARPETING
  - 178 NEEDED CARPETING • 186 NEEDED PILE CARPETING

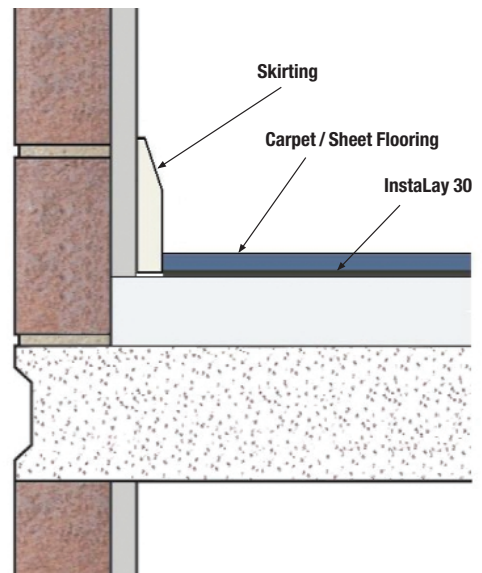
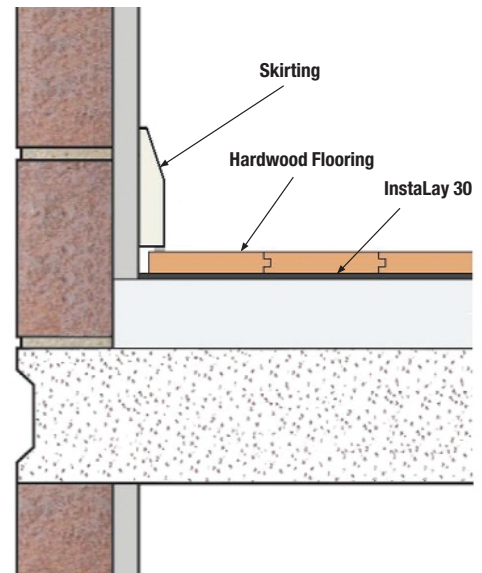

### ADHESIVE SPECIFICATION

Floor Finish	Adhesive Underlay to sub floor	Adhesive Floor finish to underlay
Wood	DO NOT bond to sub floor	To be floating floor layer
Sheet Vinyl	F40 (Dual bond) or F3	F44
Carpet (Double stick applications)	F40 (Dual bond) or F3	F3
Carpet (Single stick applications)	No bond	F3
Carpet Tiles	F40 (Dual bond) or F3	F41

Note - The information in both tables is for general guidance. We would advise before each installation to check with the adhesive manufacturer to ensure that the adhesive being used is correct for the specific floor finish and sub floor on your project. The adhesive specified are manufactured by F. Ball and Co. Ltd.

Alternatively you can use the InstaLay Peel & Stick system which incorporates an adhesive membrane to bond the floor finish to the underlay. Please see the applications below:

Floor Finish	Adhesive Underlay to sub floor	Adhesive Floor finish to underlay
Wood - solid/engineering	DO NOT bond to sub floor	InstaLay 30hg high grab Peel & Stick
Wood - click systems	DO NOT bond to sub floor	InstaLay 30lg low grab Peel & Stick
Sheet Vinyl	F40 (Dual bond) or F3	InstaLay 30hg high grab Peel & Stick
Carpet (Double stick applications)	F40 (Dual bond) or F3	InstaLay 30hg high grab Peel & Stick
Carpet (Single stick applications)	No bond	InstaLay 30hg high grab Peel & Stick
Carpet Tiles	F40 (Dual bond) or F3	InstaLay 30lg low grab Peel & Stick